

MATERIAL: STAINLESS STEEL 440C, HARDENED TO Rc 58 MIN

REV	ECO NO.	ECO TITLE	DATE
02	-----	DRAWING UPDATE	07/19/14

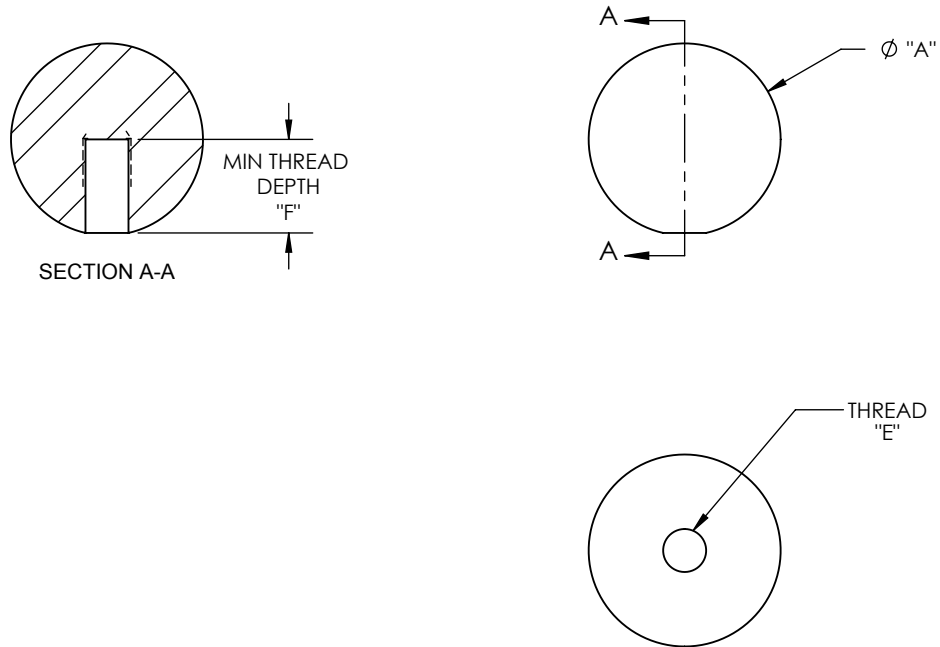

PART NUMBER	UNITS	DIAMETER "A"	THREAD "E"	MIN THREAD DEPTH "F"
250-TBR-T	in	0.250 ± 0.0001	#4-40	0.150
	mm	6.35 ± 0.003		3.81
312-TBR-T	in	0.313 ± 0.0001	#6-32	0.150
	mm	7.94 ± 0.003		3.81
375-TBR-T	in	0.375 ± 0.0001	#10-32	0.200
	mm	9.53 ± 0.003		5.08
500-TBR-T	in	0.500 ± 0.0001	1/4-20	0.250
	mm	12.70 ± 0.003		6.35
750-TBR-T	in	0.750 ± 0.0001	1/4-20	0.250
	mm	19.05 ± 0.003		6.35
100-TBR-T	in	1.000 ± 0.0001	1/4-20	0.375
	mm	25.40 ± 0.003		9.53

<div>PROPRIETARY INFORMATION</div> <div>THE INFORMATION CONTAINED IN THIS DRAWING IS THE SOLE PROPERTY OF MICRO SURFACE ENGR. INC. AND IS FURNISHED FOR INFORMATIONAL PURPOSES ONLY.</div> <div>© 2006 MICRO SURFACE ENGR. INC.</div>	UNLESS OTHERWISE SPECIFIED:		<div>Bal-tecTM</div> <div>1550 E. SLAUSON AVE</div> <div>LOS ANGELES, CA 90011</div>			
	DIMENSIONS ARE IN INCHES					
	TOLERANCES: ANGULAR: 1° TWO PLACE DECIMAL ±.01 THREE PLACE DECIMAL ±.005	TITLE		NUMBER	REV	
	INTERPRET GEOMETRIC TOLERANCING PER: ANSI Y14.5	THREADED BALL		SEE TABLE	02	
	ENGINEER	DWN BY	DATE DRAWN	SIZE	SCALE	PAGE
	GENE GLEASON	BLC	07/19/14	A	1:1	1 OF 1